

Fisher-Price®



Download free Fisher-Price® learning
apps from the Kindle Appstore,
no purchase necessary!

fisher-price.com

Consumer Information

- Please keep these instructions for future reference, as they contain important information.
- Adult setup is required.
- This product is compatible with the Kindle Fire. Device not included.
- Only use this product with your Kindle Fire device properly inserted and locked in the case. Remove any other cases from the device before inserting it in this case.
- Periodically check this product and your device for damage or cracks. Do not use if either is damaged or broken. Follow your device's instructions for use and care.
- Wipe this product with a clean, damp cloth. Do not immerse.

Open the Case

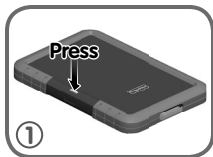

-
- Press the button on the back of the case ①, and pull the latch down ②.
 - Then, lift the back of the case to open ③.



CONSUMER ASSISTANCE

1-800-432-5437 (US & Canada)
1300 135 312 (Australia)

 service.fisher-price.com

Fisher-Price, Inc., 636 Girard Avenue, East Aurora, NY 14052.
Hearing-impaired consumers: 1-800-382-7470.

Outside the United States:

Canada: Mattel Canada Inc., 6155 Freemont Blvd.,
Mississauga, Ontario L5R 3W2; www.service.mattel.com.

Great Britain: Mattel UK Ltd, Vanwall Business Park,
Maidenhead SL6 4UB. Helpline: 01628 500303.
www.service.mattel.com/uk

Mattel Europa B.V., Gondel 1, 1186MJ Amstelveen, Nederland.

Australia: Mattel Australia Pty. Ltd., 658 Church Street,
Locked Bag #870, Richmond, Victoria 3121 Australia.

New Zealand: 16-18 William Pickering Drive,
Albany 1331, Auckland.

©2012 Mattel. All Rights Reserved.

PRINTED IN CHINA

Y3501pr-0920

Setup

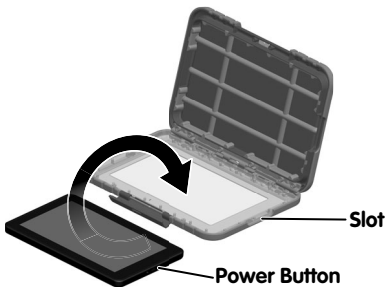

-
- Turn your device power ON.
 - Place the case with the window down on a flat surface.
 - Insert the device with the power button on the **same** end as the slot in case door.

Close the Case



- Lower the back of the case and lift the latch to lock in place.