

Fisher-Price®



fisher-price.com

Consumer Information

- Please keep these instructions for future reference, as they contain important information.
- Adult setup is required.
- This product is compatible with the iPhone®, iPhone 3G/3GS, iPhone 4/4S, iPod Touch® 2nd, 3rd and 4th Generation. Device not included.
- Only use this product with your iPod or iPhone device properly inserted and locked in the case. Remove any other cases from the device before inserting it in this case.
- Periodically check this product and your device for damage or cracks. Do not use if either is damaged or broken. Follow your device's instructions for use and care.
- Wipe this product with a clean, damp cloth. Do not immerse.

Free Learning Apps



-
- Download free Fisher-Price® learning apps from the App StoreSM, no purchase necessary!

Open the Case

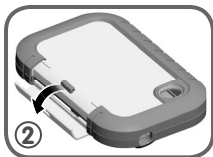

-
- Press the button on the back of the case ①, and pull the latch down ②.
 - Then, lift the back of the case to open ③.

Device Insert Installation



iPhone Insert



iPod Insert

-
- The case comes with two device inserts to fit an iPod (insert installed in case) or an iPhone (insert separate in package). The iPod insert has larger cushions and the iPhone insert has smaller cushions.

Device Insert Installation

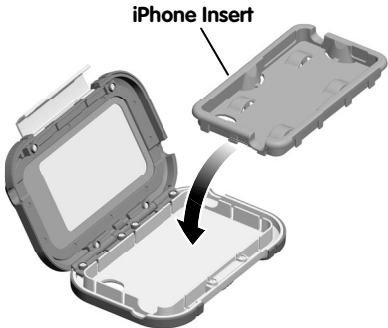

-
- The case comes with the iPod insert installed. To use an iPhone device (not included) in this case, remove the iPod insert.
 - Slide the tabs on the iPhone insert into the slots in the case. Press around the edges of the insert.

Hint: The insert is designed to fit one way, if it does not seem to fit turn it around and try again.

Setup

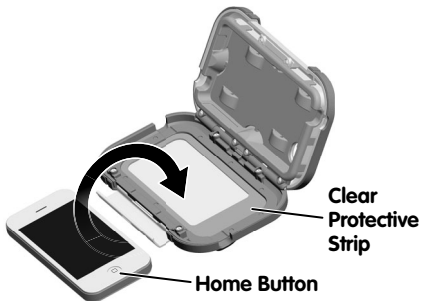

Hint: If you'd like to **block** your child from pressing the home button, follow the instructions in this step. Blocking the home button will also block the camera (if available) on the back of the device.

- Turn your device power ON.
- Place the case with the window down on a flat surface.
- Insert the device with the home button on the **same** side as the clear protective strip on the case.

Setup

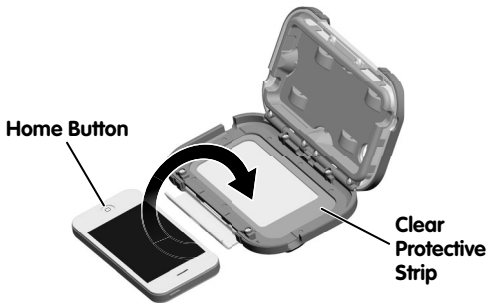

Hint: If you'd like to **allow** your child to press the home button, follow the instructions in this step.

- Turn your device power ON.
- Place the case with the window down on a flat surface.
- Insert the device with the home button on the **opposite** side of the clear protective strip on the case.

Close the Case



- Lower the back of the case and lift the latch to lock in place.



CONSUMER ASSISTANCE

1-800-432-5437 (US & Canada)

1300 135 312 (Australia)



service.fisher-price.com

Fisher-Price, Inc., 636 Girard Avenue, East Aurora, NY 14052.

Hearing-impaired consumers: 1-800-382-7470.

Outside the United States:

Canada: Mattel Canada Inc., 6155 Freemont Blvd.,
Mississauga, Ontario L5R 3W2; www.service.mattel.com.

Great Britain: Mattel UK Ltd, Vanwall Business Park,
Maidenhead SL6 4UB. Helpline: 01628 500303.
www.service.mattel.com/uk

Mattel Europa B.V., Gondel 1, 1186MJ Amstelveen, Nederland.

Australia: Mattel Australia Pty. Ltd., 658 Church Street,
Locked Bag #870, Richmond, Victoria 3121 Australia.

New Zealand: 16-18 William Pickering Drive,
Albany 1331, Auckland.

Apple, iPhone and iPod touch are trademarks of Apple Inc.,
registered in the U.S. and other countries.
App Store is a service mark of Apple Inc.

©2012 Mattel. All Rights Reserved.

® and ™ designate U.S. trademarks of Mattel, except as noted.