

**Fisher-Price®**

**W9914**



**fisher-price.com**

# Consumer Information



## WARNING

### Prevent Entanglement Injury

- Keep mobile out of baby's reach.
- Remove mobile portion of product when baby begins to push up on hands and knees.
- This product may not attach to all crib designs. Do not add additional strings or straps to attach to crib or playpen.
- Never use mobile attached to floor base in a crib or playpen.
- When used as a floor mobile, never add strings, ties or other products.

- Please keep this instruction sheet for future reference, as it contains important information.
- Requires three "C" (LR14) **alkaline** batteries for mobile/base operation (batteries not included).
- Adult assembly is required. Tool required for assembly: Phillips screwdriver (not included).
- When used as a crib mobile, this product may be used from birth until 5 months.
- A crib mobile is intended for visual stimulation and is not to be grasped by a child.
- When used as a crib soother, this product may be used from birth until 24 months.
- Wipe this toy with a clean cloth dampened with a mild soap and water solution. Do not immerse this toy. The soft toys are surface washable.
- This toy has no consumer serviceable parts. Do not take this toy apart.
- If this product begins to operate erratically, you may need to reset the electronics. Slide the power/volume switch off and then back on.

### ICES-003

This Class B digital apparatus complies with Canadian ICES-003.

Operation is subject to the following two conditions: (1) this device may not cause harmful interference and (2) this device must accept any interference received, including interference that may cause undesired operation.

### NMB-003

Cet appareil numérique de la classe B est conforme à la norme NMB-003 du Canada.

L'utilisation de ce dispositif est autorisée seulement aux conditions suivantes: (1) il ne doit pas produire de brouillage et (2) l'utilisateur du dispositif doit être prêt à accepter tout brouillage radioélectrique reçu, même si ce brouillage est susceptible de compromettre le fonctionnement du dispositif.

## Parts

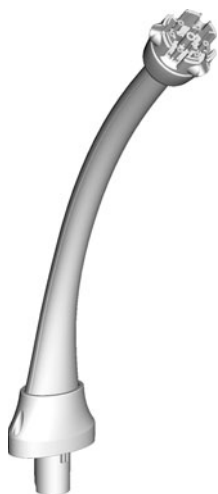

**Mobile Arm**



**3 Large Spokes**



**Soother**



**3 Toys**



**Mobile Cap**

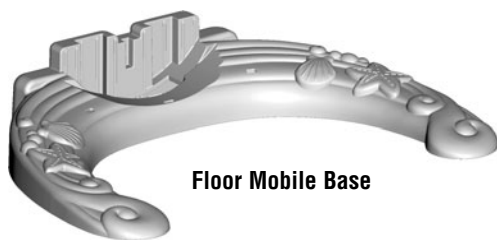

**Floor Mobile Base**

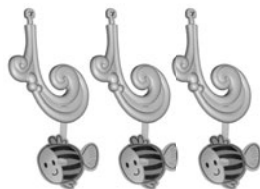

**3 Small Spokes**

**Note:** All of the screws used to assemble this toy are attached to the product. Follow these instructions carefully to fully secure the screws. Tighten and loosen all screws with a Phillips screwdriver. Do not over-tighten the screws.



## CONSUMER ASSISTANCE

1-800-432-5437 (US & Canada)  
1300 135 312 (Australia)



[service.fisher-price.com](http://service.fisher-price.com)

Fisher-Price, Inc., 636 Girard Avenue, East Aurora, NY 14052.  
Hearing-impaired consumers: 1-800-382-7470.

### Outside the United States:

Canada: Mattel Canada Inc., 6155 Freemont Blvd.,  
Mississauga, Ontario L5R 3W2; [www.service.mattel.com](http://www.service.mattel.com).

Great Britain: Mattel UK Ltd, Vanwall Business Park,  
Maidenhead SL6 4UB. Helpline: 01628 500303.  
[www.service.mattel.com/uk](http://www.service.mattel.com/uk)

Mattel Europa B.V., Gondel 1, 1186MJ Amstelveen, Nederland.

Australia: Mattel Australia Pty. Ltd., 658 Church Street,  
Locked Bag #870, Richmond, Victoria 3121 Australia.

New Zealand: 16-18 William Pickering Drive,  
Albany 1331, Auckland.

## FCC Statement (United States Only)

This equipment has been tested and found to comply with the limits for a Class B digital device, pursuant to Part 15 of the FCC Rules. These limits are designed to provide reasonable protection against harmful interference in a residential installation. This equipment generates, uses and can radiate radio frequency energy and, if not installed and used in accordance with the instructions, may cause harmful interference to radio communications. However, there is no guarantee that interference will not occur in a particular installation. If this equipment does cause harmful interference to radio or television reception, which can be determined by turning the equipment off and on, the user is encouraged to try to correct the interference by one or more of the following measures:

- Reorient or relocate the receiving antenna.
- Increase the separation between the equipment and receiver.
- Consult the dealer or an experienced radio/TV technician for help.

Note: Changes or modifications not expressly approved by the manufacturer responsible for compliance could void the user's authority to operate the equipment.

This device complies with Part 15 of the FCC Rules. Operation is subject to the following two conditions: (1) this device may not cause harmful interference and (2) this device must accept any interference received, including interference that may cause undesired operation.

# Battery Installation

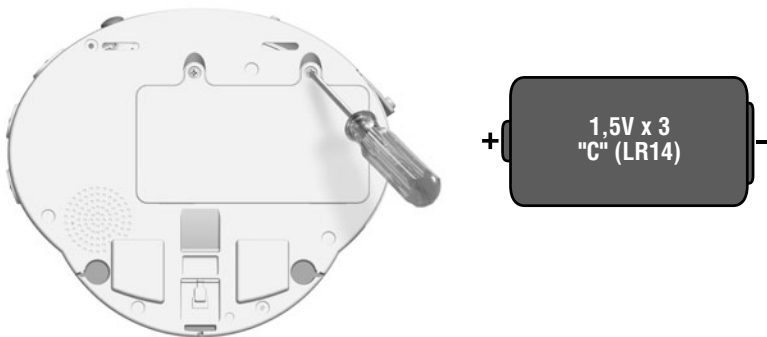

- Loosen the screws in the soother battery compartment door and remove the door.
- Insert three "C" (LR14) **alkaline** batteries.

**Hint:** We recommend using **alkaline** batteries for longer battery life.

- Replace the battery compartment door and tighten the screws.
- When sounds or motion become faint or stop, it's time for an adult to change the batteries.



- Protect the environment by not disposing of this product with household waste (2002/96/EC). Check your local authority for recycling advice and facilities.

## Battery Safety Information

**In exceptional circumstances, batteries may leak fluids that can cause a chemical burn injury or ruin your product. To avoid battery leakage:**

- Do not mix old and new batteries or batteries of different types: alkaline, standard (carbon-zinc) or rechargeable (nickel-cadmium).
- Insert batteries as indicated inside the battery compartment.
- Remove batteries during long periods of non-use. Always remove exhausted batteries from the product. Dispose of batteries safely. Do not dispose of this product in a fire. The batteries inside may explode or leak.
- Never short-circuit the battery terminals.
- Use only batteries of the same or equivalent type, as recommended.
- Do not charge non-rechargeable batteries.
- Remove rechargeable batteries from the product before charging.
- If removable, rechargeable batteries are used, they are only to be charged under adult supervision.

# Assembly

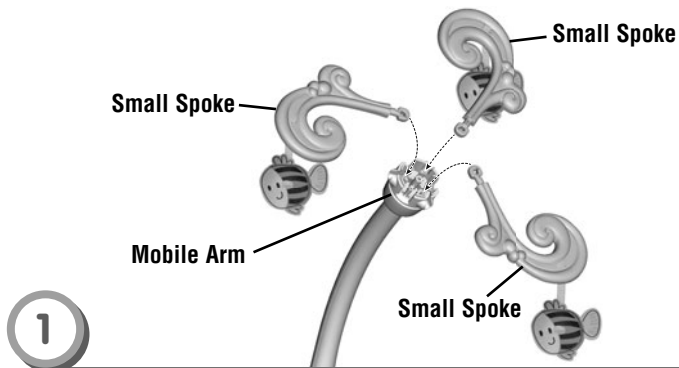

- Fit the small spokes onto the pegs on the mobile arm.

*Hint: The spokes are designed to fit on alternating pegs one way. If a small spoke does not seem to fit, try the next peg.*

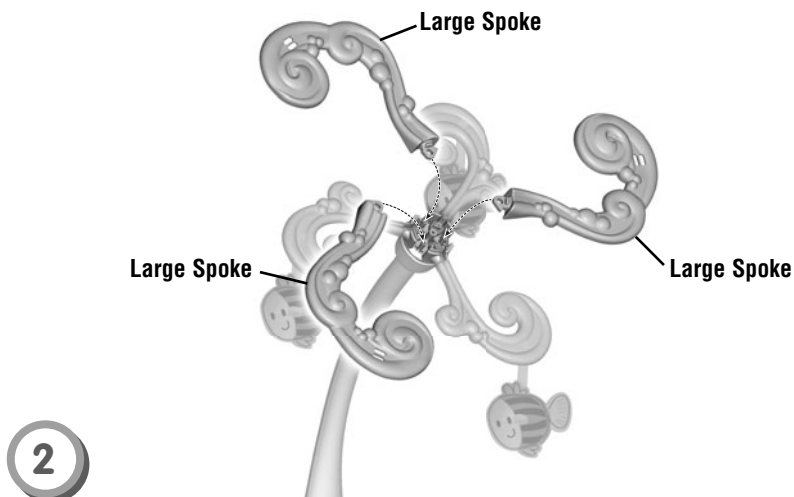

- Fit the large spokes onto the remaining pegs on the mobile arm.

# Assembly

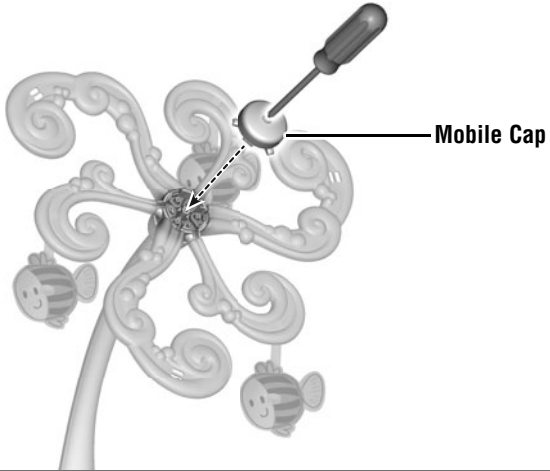

3

- Fit the mobile cap over the ends of the spokes and onto the top of the mobile arm.
- Tighten the screw in the center of the mobile cap.

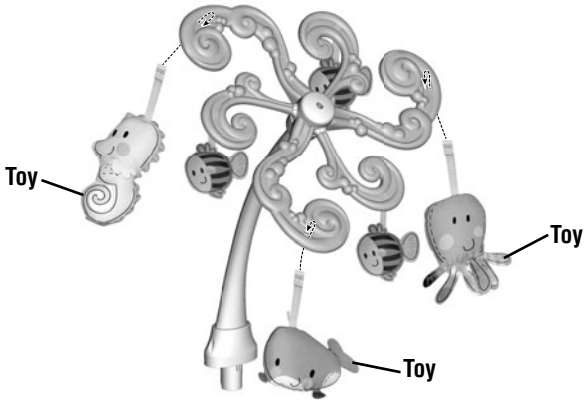

4

- First fit the T-end of the strap on a mobile toy up through the outer slot in a large spoke.
- Then, fit the T-end of the strap down through the inside slot in the same large spoke.
- Repeat this procedure to attach the remaining toys.
- Pull down on each toy to be sure it is secure.

# Assembly

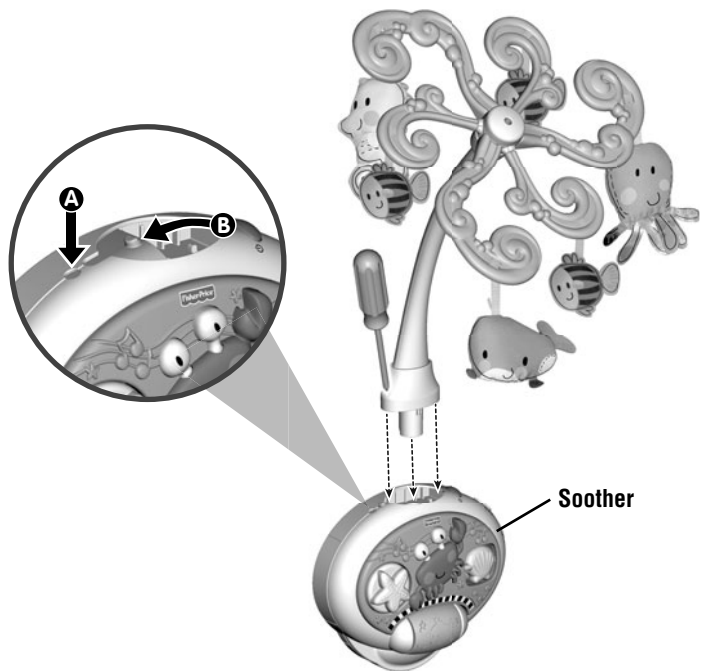

5

- First, press the button on the soother next to the socket **A** and then slide the socket door open **B**.
- Fit the mobile arm into the socket in the soother and tighten **both** screws.



## Crib Attachment

**IMPORTANT!** Always attach all provided fasteners (strings, straps, clamps, etc.) tightly to a crib or playpen according to the instructions. Do not add additional strings or straps to attach to a crib. Check frequently.

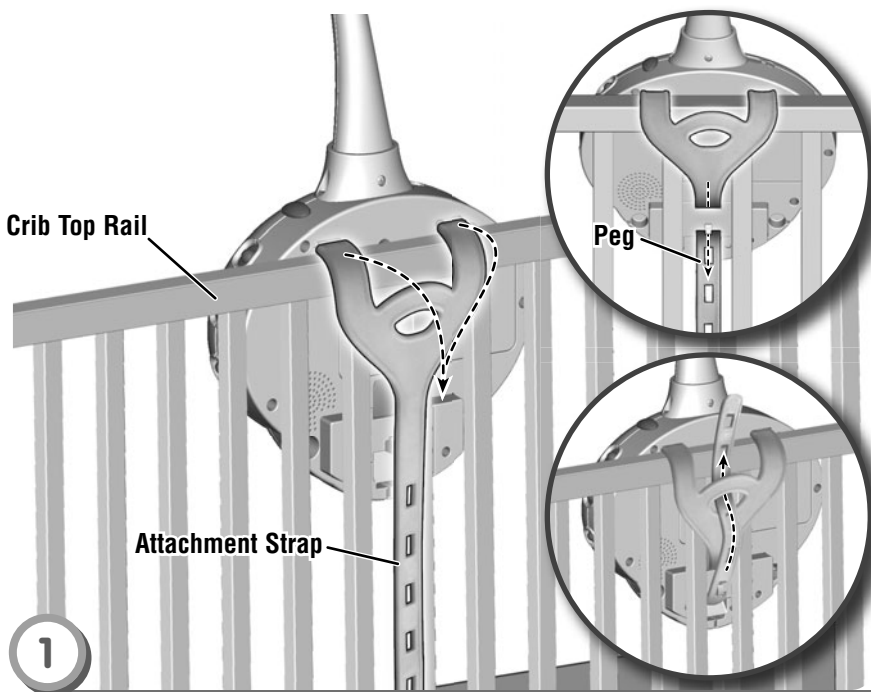

- Position the toy inside the crib.
- Wrap the toy's attachment strap around the crib top rail.
- Slide the end of the attachment the slot on the back of the toy.
- Pull the end of the attachment strap and fasten the strap slot to the peg on the back of the toy.

**Note:** This toy should be snug against the crib rail and spindles. Use the strap slot that provides the tightest fit.

- If you have excess strap, slide the free end of the attachment strap up through the slot at the top of the attachment strap.

## Crib Attachment

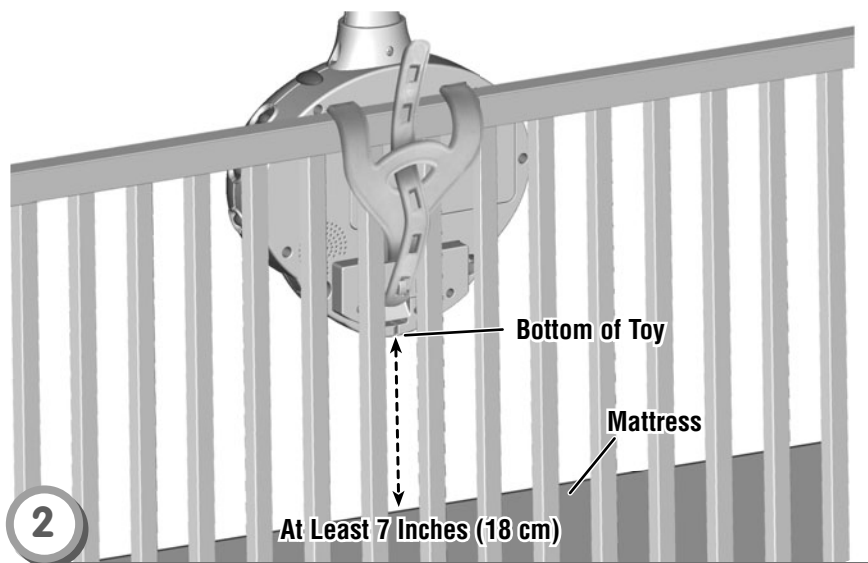

- Make sure the distance between the bottom of the toy and the crib mattress is **at least 7 inches (18 cm)**.
- If the distance is less than 7 inches (18 cm): readjust the attachment strap to lift the product; or lower the crib mattress.

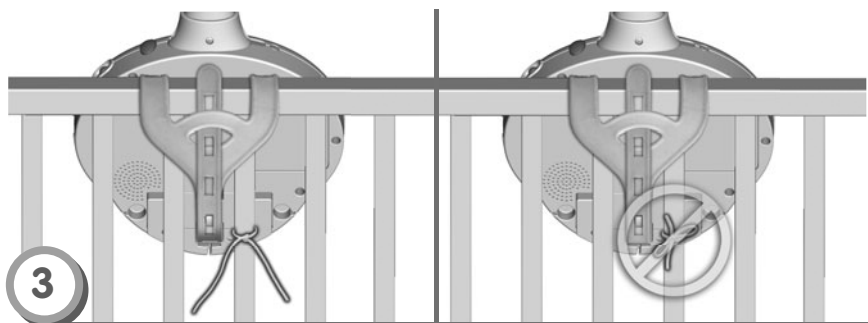

- Tie the toy's strings to a crib spindle.

**Note:** It is better to tie the strings in a knot than a bow, since a bow may be easily untied.

# Convert to Crib Soother

Remove the mobile and use as a soother attached to the crib.



1

- Loosen both screws in the arm near the soother. Lift and remove the arm.
  - Close the socket door on top of the soother.
- Hint:** *The socket door must be completely closed for use as a soother.*
- Store the mobile in a safe place for future use.

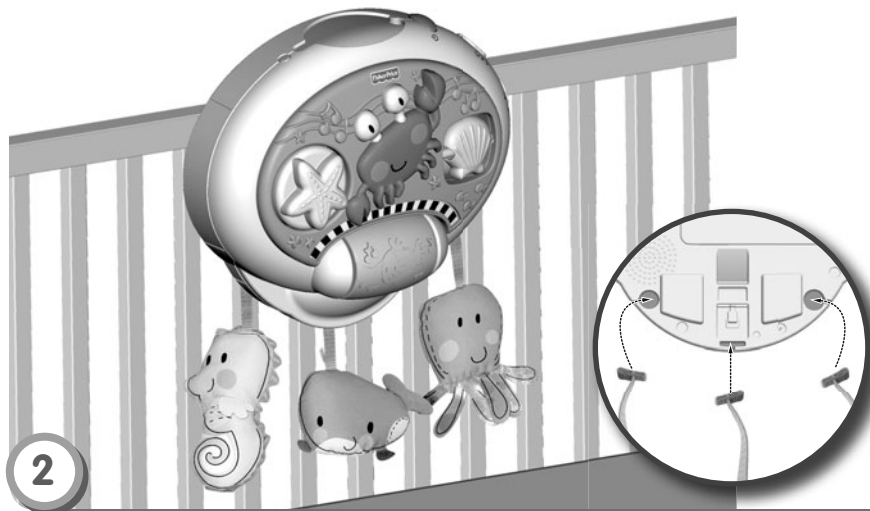

2

- The toys can be removed from the mobile large spokes and inserted into the openings in the back of the soother.
- Fit the T-end of the strap on each toy through an opening in the back of the soother.
- Pull down on each toy to be sure it is secure.

# Floor Mobile

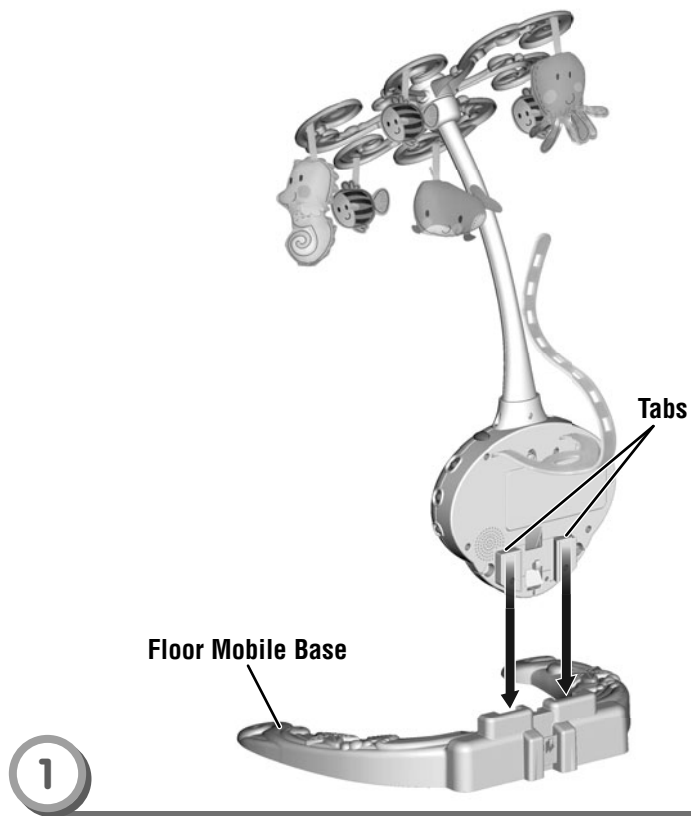

- Remove the toy from crib.
- Slide the tabs on the back of the soother into the slots in the floor mobile base.

## Floor Mobile



2

- Slide the end of the attachment strap down through the slot in the floor mobile base.

# Floor Mobile

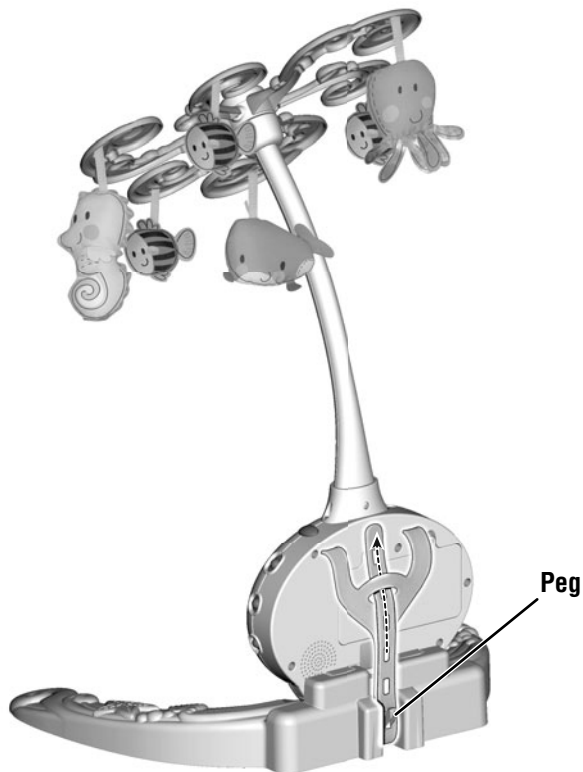

3

- Pull the end of the attachment strap up and fasten the slot on the strap to the peg on the back of the floor mobile base.
- If you have excess strap, slide the free end of the attachment strap through the slot in the top of the attachment strap.

# Floor Mobile

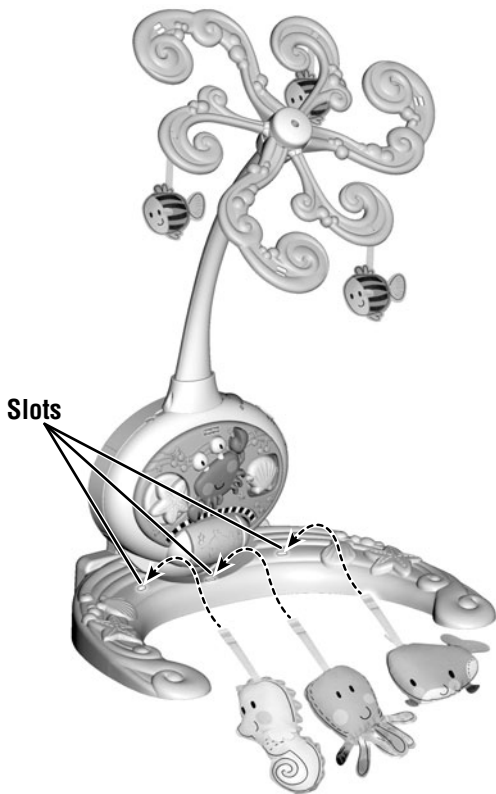

- 4
- Remove the toys from the mobile large spokes.
  - Fit the T-end of the straps on the toys into the slots in the top side of the floor mobile base.

# Soothe and Entertain Baby!

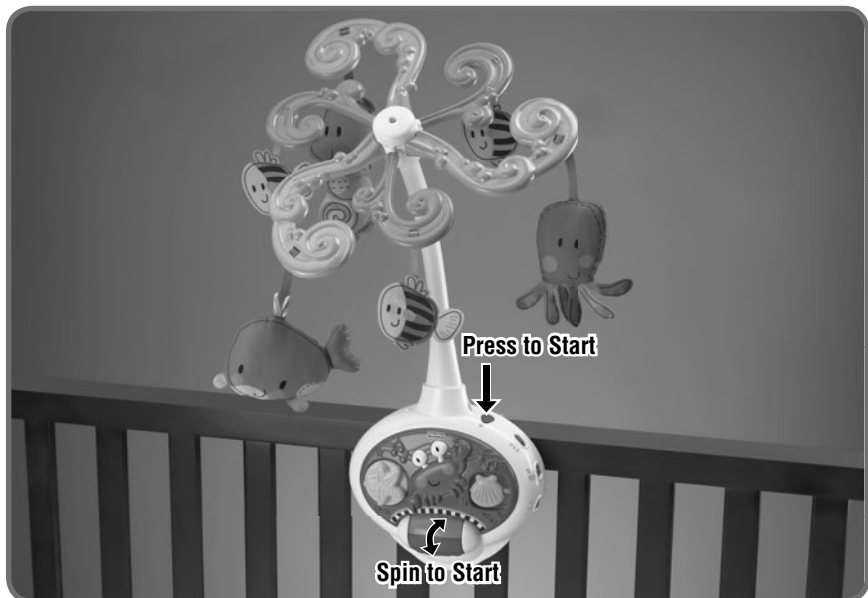

- First, turn on power and select volume level, music/sounds/mobile.



- Slide the **power/volume switch** to ON with low volume ◀) or ON with high volume ▶)). When finished using this toy, slide the switch OFF ○.



- Slide the **sound switch** to choose playful music and nature sounds 🌟 or soothing music 🎵.



- Slide the **mode switch** to choose music and motion 🎵🔄 or music only 🎵.

- Now, spin the roller or press the button to start music/motion!