

Fisher-Price®

W0429



Please keep this instruction sheet for future reference,
as it contains important information.

Adult assembly is required.

Tool required for assembly: Phillips screwdriver
(not included)

Wipe this toy with a clean cloth dampened
with a mild soap and water solution.

www.fisher-price.com

Assembled Parts



Ladder



Front Cabin



Roof

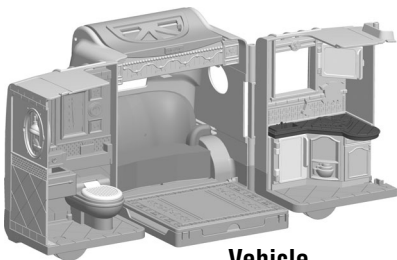

Vehicle

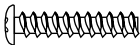

#6 x 5/8" (1,6 cm) Screw - 4

Shown Actual Size

Tighten the screws with a Phillips screwdriver.
Do not over-tighten.

Assembly



CAUTION

This product contains small parts
in an unassembled state.
Adult assembly is required.

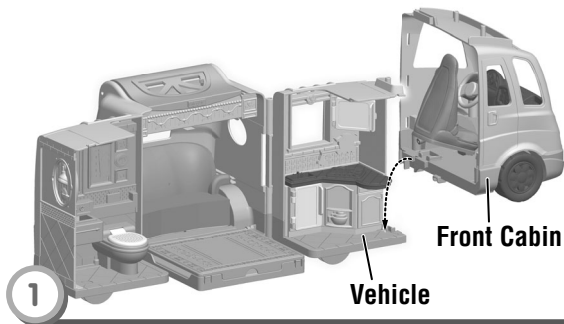

- Fit the tab on the bottom of the front cabin into the slot in the vehicle.

Assembly

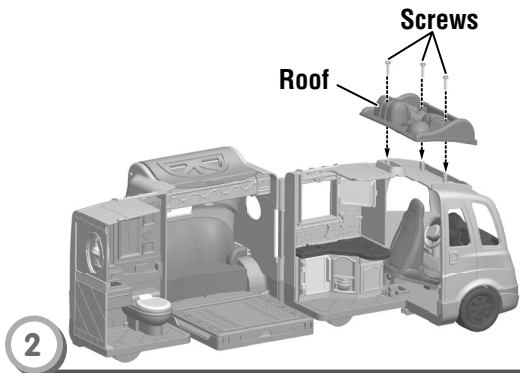

- Fit the roof onto the top of the front cabin and vehicle.
- Insert three screws into the roof and tighten.

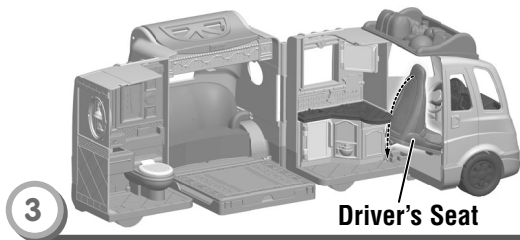

- Lower the driver's seat and hold in place.

Assembly

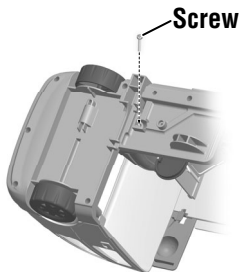

4

BOTTOM VIEW

- While holding the front cabin and the vehicle together, carefully turn the vehicle over.
- Insert a screw into the bottom of vehicle and tighten.

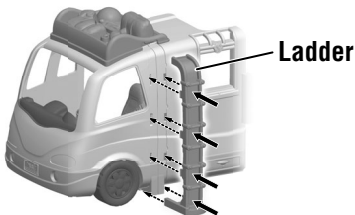

5

- Fit the tabs on the ladder into the slots on the side of the vehicle.
- Push the ladder near each set of tabs to “snap” in place.



CONSUMER ASSISTANCE

1-800-432-5437 (US & Canada)

1300 135 312 (Australia)



service.fisher-price.com

Fisher-Price, Inc., 636 Girard Avenue, East Aurora, NY 14052.

Hearing-impaired consumers: 1-800-382-7470.

Outside the United States:

Canada: Mattel Canada Inc., 6155 Freemont Blvd.,
Mississauga, Ontario L5R 3W2; www.service.mattel.com.

Great Britain: Mattel UK Ltd, Vanwall Business Park,
Maidenhead SL6 4UB. Helpline: 01628 500303.
www.service.mattel.com/uk

Mattel Europa, B.V., Gondel 1, 1186 MJ Amstelveen, Nederland.

Australia: Mattel Australia Pty. Ltd., 658 Church Street,
Locked Bag #870, Richmond, Victoria 3121 Australia.

New Zealand: 16-18 William Pickering Drive,
Albany 1331, Auckland.

Fisher Price, Inc., a subsidiary of Mattel, Inc., East Aurora, NY 14052 U.S.A.

©2011 Mattel, Inc. All Rights Reserved. ® and ™ designate U.S. trademarks of Mattel, Inc.

PRINTED IN CHINA

W0429pr-0920