

Fisher-Price®

X7751



Please keep this instruction sheet for future reference,
as it contains important information.

Requires four “C” batteries for operation (included).

Batteries included are for demonstration purposes only.

Adult assembly is required for crib attachment and battery replacement.

Tool required: Phillips screwdriver (not included).

fisher-price.com

Battery Replacement

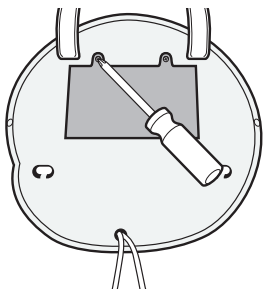

For best performance, we recommend replacing the batteries that came with this toy with four, new “C” (LR14) batteries.

- Locate the battery compartment on the back of the toy.
- Loosen the screws in the battery compartment door with a Phillips screwdriver and remove the door. Remove the exhausted batteries and dispose of them properly.
- Insert four, new “C” (LR14) **alkaline** batteries.
- Replace the battery compartment door and tighten the screws. Do not over-tighten.
- If this toy begins to operate erratically, you may need to reset the electronics. Slide the power/volume switch off and back on.
- If sounds, lights or motions become faint or stop, it's time for an adult to change the batteries.

Battery Safety Information

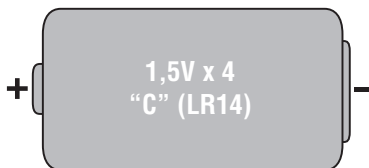

In exceptional circumstances, batteries may leak fluids that can cause a chemical burn injury or ruin your product. To avoid battery leakage:

- Do not mix old and new batteries or batteries of different types: alkaline, standard (carbon-zinc) or rechargeable (nickel-cadmium).
- Insert batteries as indicated inside the battery compartment.
- Remove batteries during long periods of non-use. Always remove exhausted batteries from the product. Dispose of batteries safely. Do not dispose of product in a fire. The batteries inside may explode or leak.
- Never short-circuit the battery terminals.
- Use only batteries of the same or equivalent type, as recommended.
- Do not charge non-rechargeable batteries.
- Remove rechargeable batteries from the product before charging.
- If removable, rechargeable batteries are used, they are only to be charged under adult supervision.

Gentle Soothing



Press to start or stop music/lights/sounds

Power/Volume Switch

- Slide to ON with low volume ◀▶, ON with medium volume ◀▶▶, ON with high volume ◀▶▶▶) or OFF ○.

Sounds Select Switch

- Choose:
 - 🌿 Nature Sounds
 - 🎵 Classical
 - 🎶 Lullabies

Mode Switch

- Choose:
 - 🎵 **Music Only** - plays approximately 18 minutes of music/sounds
 - 🎵💡 **Music and Lights** - plays approximately 12 minutes of music/sounds/lights
 - 🎵💡🔄 **Music, Lights and Motion** - plays approximately 6 minutes of music/sounds/lights/motion

? **CONSUMER ASSISTANCE**
 1-800-432-5437 (US & Canada)
 1300 135 312 (Australia)

service.fisher-price.com

Fisher-Price, Inc., 636 Girard Avenue, East Aurora, NY 14052.
 Hearing-impaired consumers: 1-800-382-7470.

Outside the United States:
 Canada: Mattel Canada Inc., 6155 Freemont Blvd.,
 Mississauga, Ontario L5R 3W2; www.service.mattel.com.
 Great Britain: Mattel UK Ltd, Vanwall Business Park,
 Maidenhead SL6 4UB. Helpline: 01628 500303.
 www.service.mattel.com/uk
 Mattel Europa B.V., Gondel 1, 1186MJ Amstelveen, Nederland.
 Australia: Mattel Australia Pty. Ltd., 658 Church Street,
 Locked Bag #870, Richmond, Victoria 3121 Australia.
 New Zealand: 16-18 William Pickering Drive,
 Albany 1331, Auckland.

ICES-003

- This Class B digital apparatus complies with Canadian ICES-003.
- Operation is subject to the following two conditions: (1) this device may not cause harmful interference and (2) this device must accept any interference received, including interference that may cause undesired operation.

NMB-003

- Cet appareil numérique de la classe B est conforme à la norme NMB-003 du Canada.
- L'utilisation de ce dispositif est autorisée seulement aux conditions suivantes : (1) il ne doit pas produire de brouillage et (2) l'utilisateur du dispositif doit être prêt à accepter tout brouillage radioélectrique reçu, même si ce brouillage est susceptible de compromettre le fonctionnement du dispositif.

FCC Statement (United States Only)

This equipment has been tested and found to comply with the limits for a Class B digital device, pursuant to Part 15 of the FCC Rules. These limits are designed to provide reasonable protection against harmful interference in a residential installation. This equipment generates, uses and can radiate radio frequency energy and, if not installed and used in accordance with the instructions, may cause harmful interference to radio communications. However, there is no guarantee that interference will not occur in a particular installation.

If this equipment does cause harmful interference to radio or television reception, which can be determined by turning the equipment off and on, the user is encouraged to try to correct the interference by one or more of the following measures:

- Reorient or relocate the receiving antenna.
- Increase the separation between the equipment and receiver.
- Consult the dealer or an experienced radio/TV technician for help.

Note: Changes or modifications not expressly approved by the manufacturer responsible for compliance could void the user's authority to operate the equipment. This device complies with Part 15 of the FCC Rules. Operation is subject to the following two conditions: (1) This device may not cause harmful interference and (2) this device must accept any interference received, including interference that may cause undesired operation.

© Disney

©2012 Mattel. All Rights Reserved. ® and ™ designate U.S. trademarks of Mattel, except as noted.

PRINTED IN CHINA

X7751pr-0920

Crib Attachment

WARNING

Prevent Entanglement Injury

This product may not attach to all crib designs. Do not add additional strings or straps to attach to a crib or playpen. Use **ONLY** attached to a crib or playpen.

IMPORTANT! Always use the straps provided to attach this toy to a crib.

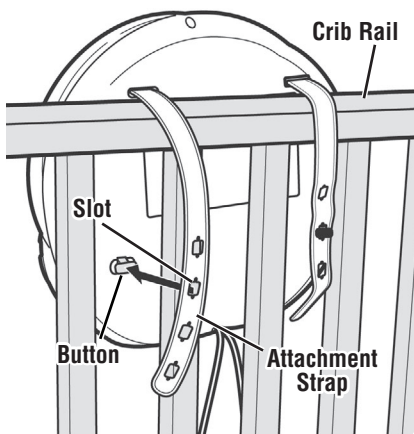

1

Back View

- Position the toy inside the crib.
- Wrap one of the toy's attachment straps around the crib rail.

- Fasten the attachment strap slot to the button on the back of the toy. This toy should be snug against the crib rail and spindles. Use the strap slot that provides the tightest fit.
- Repeat this procedure to secure the other attachment strap.

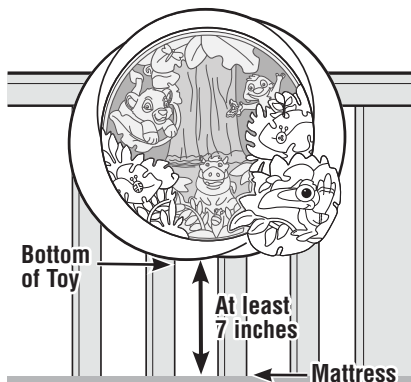

2

- If the distance between the toy and the mattress is less than 7 inches, lower the crib mattress.

Crib Attachment

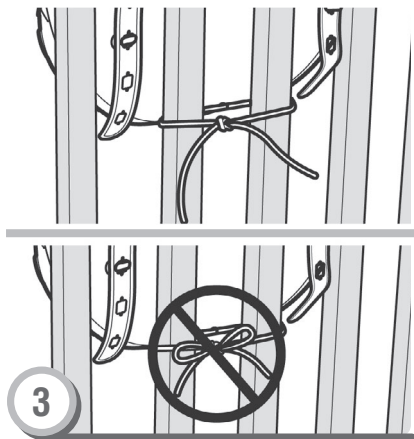

- Wrap the toy's strings around the crib spindles and tie in a knot.

Note: It is better to tie the strings in a knot than a bow, since a bow may be easily untied.

Care

- To clean, wipe the surface of this toy with a damp cloth. Do not immerse this toy.
- Do not drop this toy on a hard surface.
- This toy has no consumer serviceable parts. Please do not take this toy apart.



- Protect the environment by not disposing of this product with household waste (2002/96/EC). Check your local authority for recycling advice and facilities.