

#J7526 Barbie Princess Enchanted Sounds™

Size : 4.25 x 5.5"

Fisher-Price I CAN PLAY! PIANO

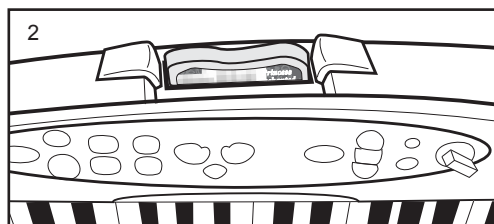
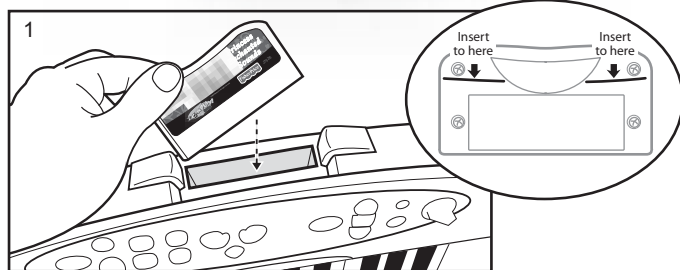

Insert your new software cartridge into the keyboard as shown until it clicks completely into place and the lines on the cartridge line up with the piano housing.

- Turn on your TV.
- Press and hold the ON/OFF button on the keyboard until the button remains lit and the TV screen comes on.

That's it – you're ready to play!

Now just follow the instructions on the screen.

J7526/J7529 Asst.

"Constant as the Stars Above" from
"Barbie as Rapunzel"
Music by Arnie Roth © 2002 Mattel, Inc.
All Rights Reserved.

"Written in Your Heart" from
"Barbie as the Princess and the Pauper"
Music by Megan Cavallari © 2004 Mattel, Inc.
All Rights Reserved.

"I Am A Girl Like You" from
"Barbie as the Princess and the Pauper"
Music by Megan Cavallari © 2004 Mattel, Inc.
All Rights Reserved.

"The Cat's Meow" from
"Barbie as the Princess and the Pauper"
Music by Megan Cavallari © 2004 Mattel, Inc.
All Rights Reserved.

"To Be a Princess" from
"Barbie as the Princess and the Pauper"
Music by Megan Cavallari © 2004 Mattel, Inc.
All Rights Reserved.

"If You Love Me for Me" from
"Barbie as the Princess and the Pauper"
Music by Megan Cavallari © 2004 Mattel, Inc.
All Rights Reserved.

"Dance of the Sugar Plum Fairies" from

"Barbie in the Nutcracker"
Music by Peter Tchaikovsky,
Arranged by Arnie Roth,
© 2001 Mattel, Inc. All Rights Reserved.

"Theme from Swan Lake" from
"Barbie of Swan Lake"
Music by Peter Tchaikovsky,
Arranged by Arnie Roth,
© 2003 Mattel, Inc. All Rights Reserved.

BARBIE and associated trademarks and trade dress are owned by Mattel, Inc. Fisher-Price, Inc., a subsidiary of Mattel, Inc., East Aurora, NY 14052 U.S.A.

PRINTED IN CHINA.

Manufactured for Fisher-Price.
©2006 Mattel, Inc.

All Rights Reserved.
Fisher-Price and the Fisher-Price logo are U.S. trademarks of Mattel, Inc.

Questions?
service.fisher-price.com
In US and Canada
1-800-432-5437

J7526/J7529 Asst.

J7526-0920

Item No : J7526/J7529
Version : English
Size : 4.25 x 5.5" (double)
Paper : Woodfree paper 80 gsm
Color : Black
Date : Mar 14, 2006 (AW)